



# RESIDENTIAL PLASTIC TOILET SEAT

MODEL #

COLOR #

**1100EC**

## DESCRIPTION:

Closed front with cover, elongated, injection molded solid plastic toilet seat. Features four molded-in bumpers, color-matched Easy•Clean & Change™ hinges with non-corrosive, top-tightening bolts and wing nuts. This seat complies with American National Standard Z124.5 Toilet (Water Closet) Seats as a Class Commercial Heavy Duty.

## SPECIFICATIONS:

Size:	Elongated
Material:	Plastic
Style:	Closed Front with Cover
Bumpers:	Four
Hinges:	Plastic Easy•Clean & Change™
Fastening System:	Non-Corrosive Bolts and Wing Nuts

## FEATURES:

Easy•Clean & Change™

Non-Corrosive Bolts and Wing Nuts

## DIMENSIONS:

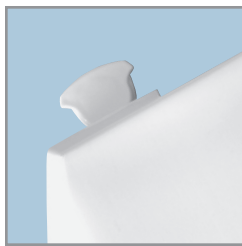

PLASTIC EASY•CLEAN &  
CHANGE™ HINGES



TWIST HINGES TO UNLOCK



EASY REMOVAL OF SEAT  
FOR THOROUGH CLEANING



NON-CORROSIVE BOLTS  
AND WING NUTS

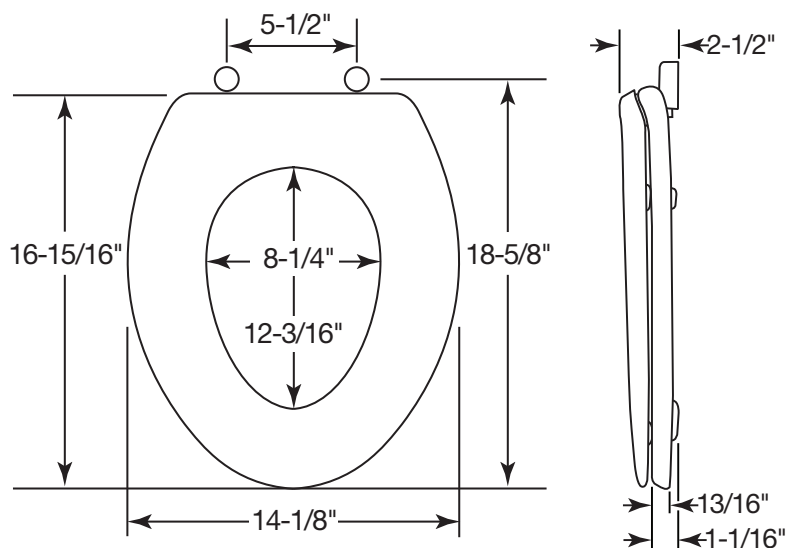

Bemis Manufacturing Co., Sheboygan Falls, WI 53085  
www.BemisSeats.com

Phone: 920-467-4621 | 800-558-7651 Fax: 920-467-8573